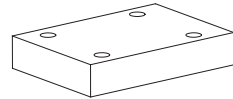

**Blanking plate**  
**Linking plate**  
 •  $p_{max} = 350 \text{ bar}$ 
**NG6**  
 ISO 4401-03

**DESCRIPTION**

Blanking and linking plates NG6 acc. to ISO 4401-03. The plates are zinc coated and will be supplied inclusive 4 O-rings ID 9,25x1,78 (article 160.2093).

**APPLICATION**

Blanking plates are used to seal all ports (P, A, B, T) of a NG6 interface. With linking plates selected ports of a NG6 interface can be connected. Other ports not in use are sealed.

**TYPE CODE**

|  |         |   |                          |
|--|---------|---|--------------------------|
|  | A BP 6  | # | <input type="checkbox"/> |
|  | A U 6 / | # | <input type="checkbox"/> |
| International standard interface ISO               |         |   |                          |
| Blanking plate BP                                  |         |   |                          |
| Linking plate U                                    |         |   |                          |
| Nominal size 6                                     |         |   |                          |
| Connection of ports see type code list and symbols |         |   |                          |
| Design-Index (Subject to change)                   |         |   |                          |

**DIMENSIONS**

Blanking and linking plate

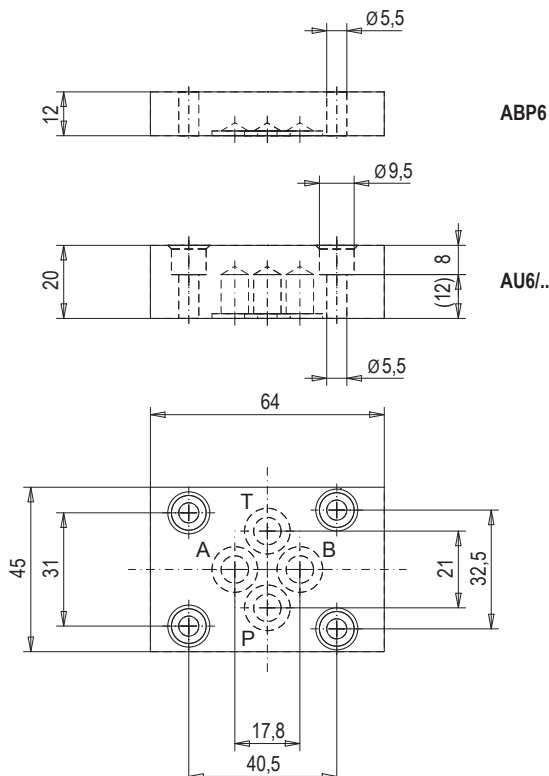
**TYPES**

| Types                  | Article no. | Symbols |
|------------------------|-------------|---------|
| <i>Blanking plate:</i> |             |         |
| ABP6                   | 173.3150    | A P T B |
| <i>Linking plate:</i>  |             |         |
| AU6 / P-B / A-T        | 173.3250    | A P T B |
| AU6 / P-A / B-T        | 173.3251    | A P T B |
| AU6 / P-A              | 173.3252    | A P T B |
| AU6 / P-B              | 173.3253    | A P T B |
| AU6 / P-T              | 173.3254    | A P T B |
| AU6 / A-T              | 173.3255    | A P T B |
| AU6 / B-T              | 173.3256    | A P T B |
| AU6 / A-B-T            | 173.3257    | A P T B |
| AU6 / A-B              | 173.3258    | A P T B |
| AU6 / P-A-B            | 173.3259    | A P T B |